

# Genuine Squirrel Airplane Kit

Designed by Inventor Darcy Whyte



## High Performance Rubber Band Flyer

Number one choice for beginners and experts world wide for fun and learning. Experience the marvel of flight hands-on by making and flying Squirrel!

Attention Beginners!

Video Instruction On-line

Requires:  
Scissors  
Craft Glue  
Glue Stick

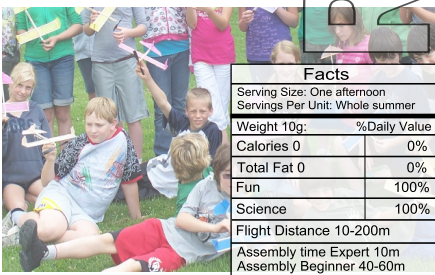

Facts	
Serving Size: One afternoon	
Servings Per Unit: Whole summer	
Weight 10g:	%Daily Value
Calories 0	0%
Total Fat 0	0%
Fun	100%
Science	100%
Flight Distance 10-200m	
Assembly time Expert 10m	
Assembly Beginner 40-60m	

Rubber-Power.com

- 1) Video Instruction and help on-line.**
- 2) Supplies:** Scissors, Craft Glue (carpenter or white), Glue Stick (optional)

**3) Craft Glue:** Apply to model with toothpick. Spread a thin layer quickly. Less is more.

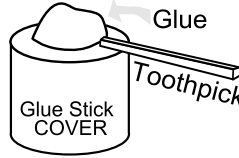

Keep a blob of glue on **flat end** of a glue stick cover.

**4) Glue Stick (Step A-E only):** Place balsa strips against table while applying glue stick or they'll break. You can use Craft Glue instead but use very little!

**5) See ruler (right)** for list of parts and lengths.

**Safety:** Children need supervision. Do not fly plane on or near roadway or other dangerous places. Do not climb trees, buildings, posts or any structure. Do not put parts in mouth. Choking hazard. Keep propeller away from eyes.

**Included:** 1/16 x 3/16" Balsa Strips: 2-12", 2-6", 6-2", 1-4", 4-1/4" Motor Stick: 1/8 x 3/8 x 12", 2-Toothpick, Propeller with mount (6"), 10" Elastic Motor Loop (1/8" rubber), #8 Elastic Band, Tissue Paper 2-17x2.5"

- A, E (12")
- N, R (6")
- J (4")
- B, C, D, I, M (2")
- F, G, L, Q (shards)

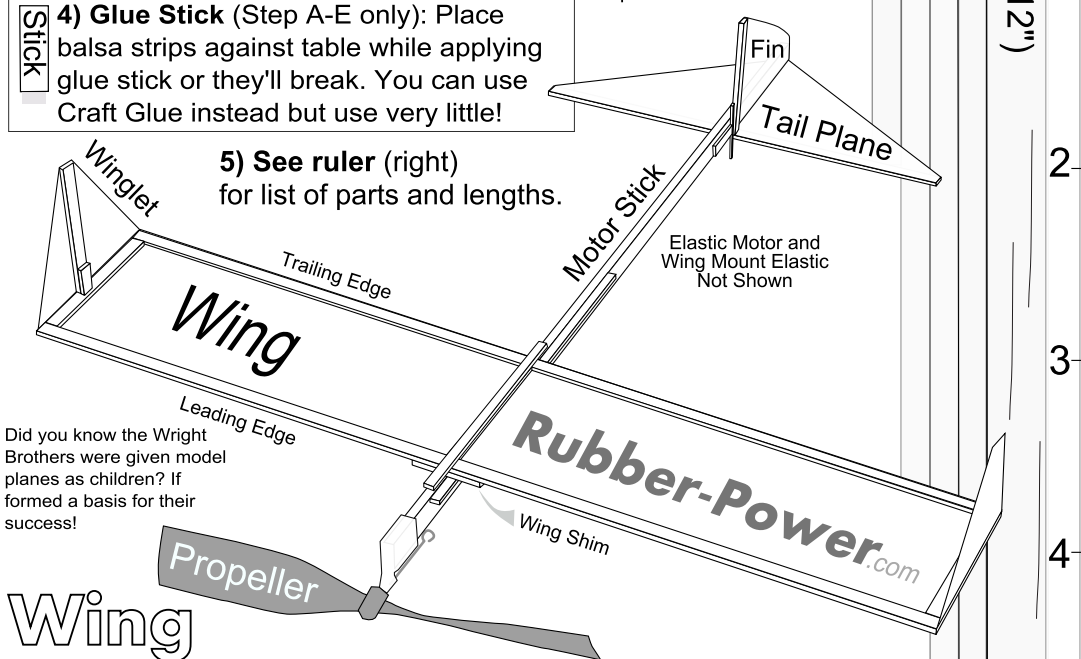

Did you know the Wright Brothers were given model planes as children? If formed a basis for their success!

### Wing

Lay Wing Tissue on flat surface. For step **A to E**, use glue stick for wood to tissue and craft glue for wood to wood.

**Glue** Craft Glue only from now on! **Glue** Glue **F, G, H, I, J**.

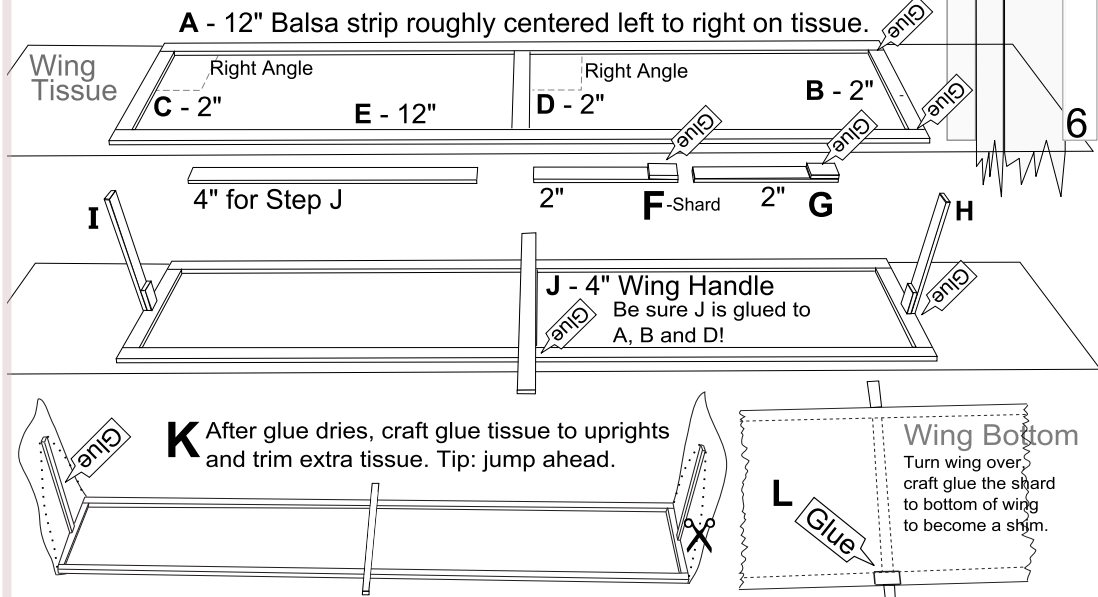

**Tailplanes** Glue **M** and **N** to another tissue strip. **Snip** off Fin and Tailplane on dotted line.

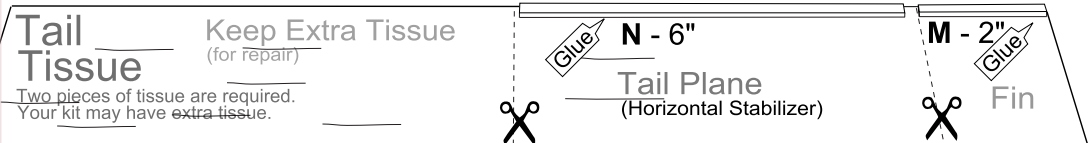

**Motorstick** The Motorstick is the thicker 12" strip. Glue O, P, Q, R on top. Make sure the 6" balsa Wing Seat (R) is nice and square against the Motorstick and is top aligned.

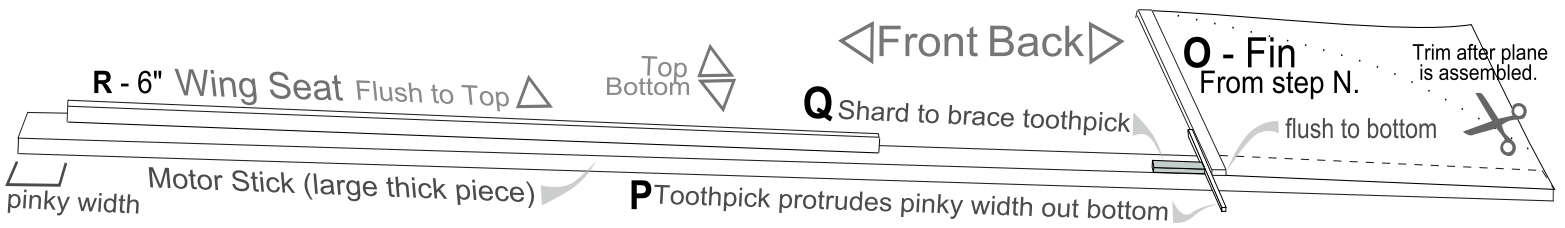

After glueing Tailplane to Motorstick (below) it's **important** to set the assembly on the edge of the table or on a glass so that the Tailplane glue joint stays square and strong. **Wait for all the glue to dry.** Trim extra tissue using sissors on the wing and tailplanes. Attach wing with small elastic (below). Pre-stretch the elastic to soften it. Strap the wing on the top of the Motorstick. Move wing carefully so it's about 1 1/4" from the front.

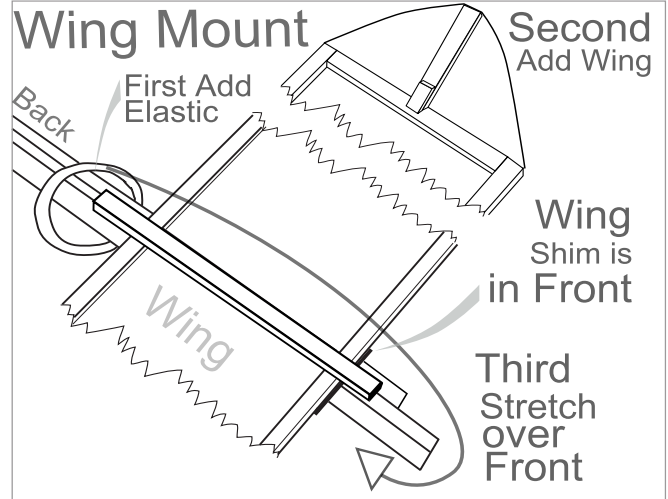
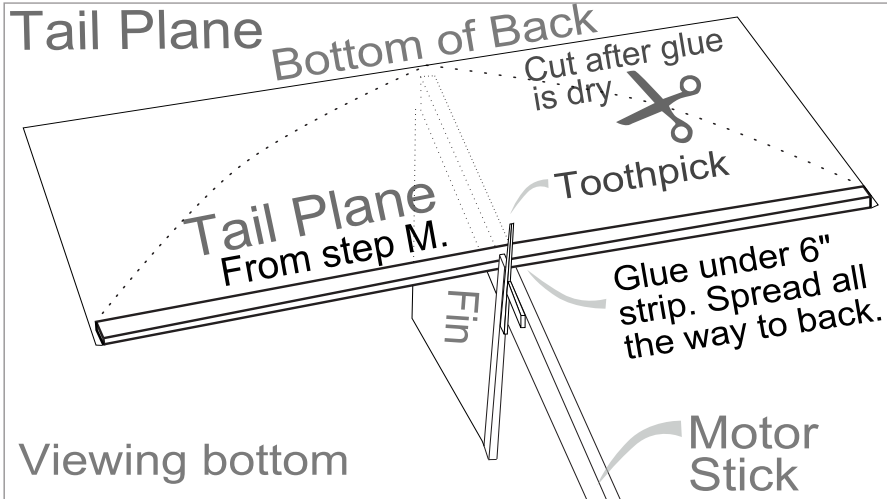

**Motor & Propeller** Tie 20" (45cm) elastic into a loop using a square knot. Loop to metal loop behind propeller. The knot goes furthest from propeller. Mount propeller on motor stick. Prop. shaft below motor stick. If propeller hub is too tight to fit, scrape wood with blade of scissors. Large elastic will hang down after you attach the propeller to the front of the plane.

**Admire your work and take pictures!!** Share pictures and video with friends and submit them to the rubber-power Web site!

## Flying

**Handling** - Pick up a Squirrel by **nose (propeller mount)**. When retrieving from bushes or other predicaments, move slowly and carefully. Store in small box with wing removed or larger box with wing installed. Avoid water or moisture.

**Winding** - Wnd and launch the plane while holding it **underneath the wing (below)**. Wind propeller clockwise from front. If elastic is too long to hook on toothpick pre-wind it (below). Then hook the elastic on the toothpick to continue winding. You will need about 150-200 turns for test flights and 300 turns for regular flying. Too many turns and the elastic can break causing damage to the plane.

## Pre-winding

Hook elastic to toothpick after pre-winding.

Continue winding after prewinding is complete.

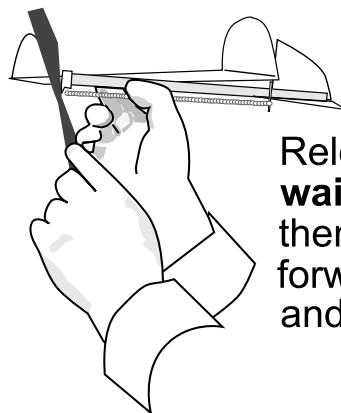

## Launch

Release propeller, **wait a second** then push plane forward **gently** and level.

**Making it Fly** - Adjusting the wing forward causes the plane to climb. Adjusting it back causes it to sink. The idea is to find the sweet spot where it climbs gently after launching. If plane is new or has not been flown for a while it may need some trim flights (test flights) in order to find the right wing position. Start with a wing adjustment about 1.25" (3cm) from front. If the plane fails to climb with 200 propeller turns, move wing forward (perhaps 1mm at a time). If the plane chugs around with its nose in the air or stalls repeatedly, move wing back a bit. Repeat launch with 200 turns and adjusting wing until it flies nicely. Then start increasing winds for each flight till you reach 400-500 turns. With care your Squirrel can last years. Happy Flying!

## Tips

Flies best with little or no wind. Write your name and phone number on your Squirrel. Add tick marks to motor stick to note wing position once wing is adjusted. Decorate your Squirrel with different colored tissue, markers and ink stamping. Attach paper aileron to rear of either wing for turning. Also can attach paper rudder to leading edge of fin.

**Broken Sticks** - Glue back with craft glue. Be sure to match the break back up exactly so that the wood grain is perfectly matched back. Use scrap balsa to splint break if necessary.

**Torn Tissue** - Make a patch out of tissue and glue it on. You can also replace sections of tissue or all the tissue.

